

EXPLORE

Four Gardens – One Botanic World

We are a leading botanic garden and a global centre for biodiversity science, horticulture, and education. All life depends on plants and fungi, but biodiversity loss and climate change are putting thousands of plant species at risk of extinction.

Across our four Gardens, we conserve one of the world's richest botanical collections. Through cutting-edge science, conservation efforts, and educational programmes, we are working to create a positive future for plants, people, and the planet.

Royal Botanic Garden Edinburgh

A World of Plants in the Heart of the City

20a Inverleith Row, Edinburgh EH3 5LR
Tel: 0131 248 2909 | rbge.org.uk

Open daily from 10am
(except 1 January and 25 December)
Free admission



Dawyck Botanic Garden

The World's Trees in the Scottish Borders

Stobo, near Peebles,
Scottish Borders EH45 9JU
Tel: 01721 760254 | rbge.org.uk/dawyck

Open daily from 10am
1 February – 30 November
Admission charge applies



Logan Botanic Garden

An Exotic Paradise for Plant Lovers

Port Logan, Stranraer,
Dumfries and Galloway DG9 9ND
Tel: 01776 860231 | rbge.org.uk/logan

Open daily from 10am
1 March – 15 November
(+ weekends in February)
Admission charge applies



Eat, Drink & Shop

Redwood Coffee is a locally-run café and kitchen located next to the Visitor Centre. Open daily from 10am – 4pm the café serves locally roasted coffee, hot food, refreshments and home baking. Daily specials are available.

Visit our Botanics Shop to browse exclusively designed homeware and locally sourced artisan items. The Plant Shop stocks an extensive range of plants and garden accessories. You can also shop online at rbgeshop.org.

Become a Member

Become a Member and lend your support to our vital role in plant research and conservation. You will be kept informed by our regular *Botanics* magazine, gain free entry to each of our four Gardens, and enjoy exclusive events and priority bookings.

Join online at rbge.org.uk/membership
or call **0131 248 2929**.

Sign up for our e-newsletter at rbge.org.uk



BENMORE BOTANIC GARDEN



Dunoon, Argyll PA23 8QU
Tel: 01369 706261
Email: benmore@rbge.org.uk
Web: rbge.org.uk/benmore

Stay in touch:
f [@benmorebotanicgarden](https://www.facebook.com/benmorebotanicgarden)
@ [@benmorebotanicgarden](https://www.instagram.com/benmorebotanicgarden)

GARDEN MAP



BENMORE BOTANIC GARDEN

Welcome to Argyll's Magnificent Mountainside Garden. The 120-acre grounds are rich in history and surrounded by dramatic woodland scenery. Our Living Collection is world-famous, with rare and iconic plants from regions such as the Himalayas, China, Japan, and North and South America.

Don't miss the following highlights:

Giants of Benmore: Enter through Redwood Avenue, featuring 160-year-old giant redwoods. Towering Douglas firs, Scots pines and monkey puzzle trees create a breathtaking landscape.

The Victorian Fernery: Showcasing lush greenery and diverse ferns in an historic Victorian structure.

A Riot of Rhododendrons: Enjoy a dazzling display of over 300 species.

Storm Éowyn significantly impacted the Garden in January 2025 and signs of its damage can still be seen. Please follow any updated signage for closures or detours.

Explore

The orange **Easy Access Route** is mostly level and is suitable for wheelchairs and buggies. All other parts of the Garden are hilly with many steep and stepped paths. Take in spectacular views at the peak of the View Point, capturing the lush Garden and rugged countryside beyond.

⚠ Caution – open water

Highlights

(Distance from Visitor Centre, approximate time allowance)

G **Courtyard Gallery** (500m, allow 12 mins)
The former sawmill hosts a programme of exhibitions.

J **Golden Gates** (925m, allow 20 mins) – These once formed the grand entrance to the former estate.

K **Fernery** (1,245m, allow 30 mins) – This unusual Victorian building showcases our fern collections.

Mountain Shelters

L **Bhutanese Pavilion** (1,510m, allow 35 mins)

M **Chilean Shelter 'The Condor'** (1,610m, allow 35 mins)

N **Chilean Viewpoint Refuge** (1,450m, allow 35 mins)

O **Wright Smith Memorial Viewpoint and Shelter** (1,150m, allow 30 mins)

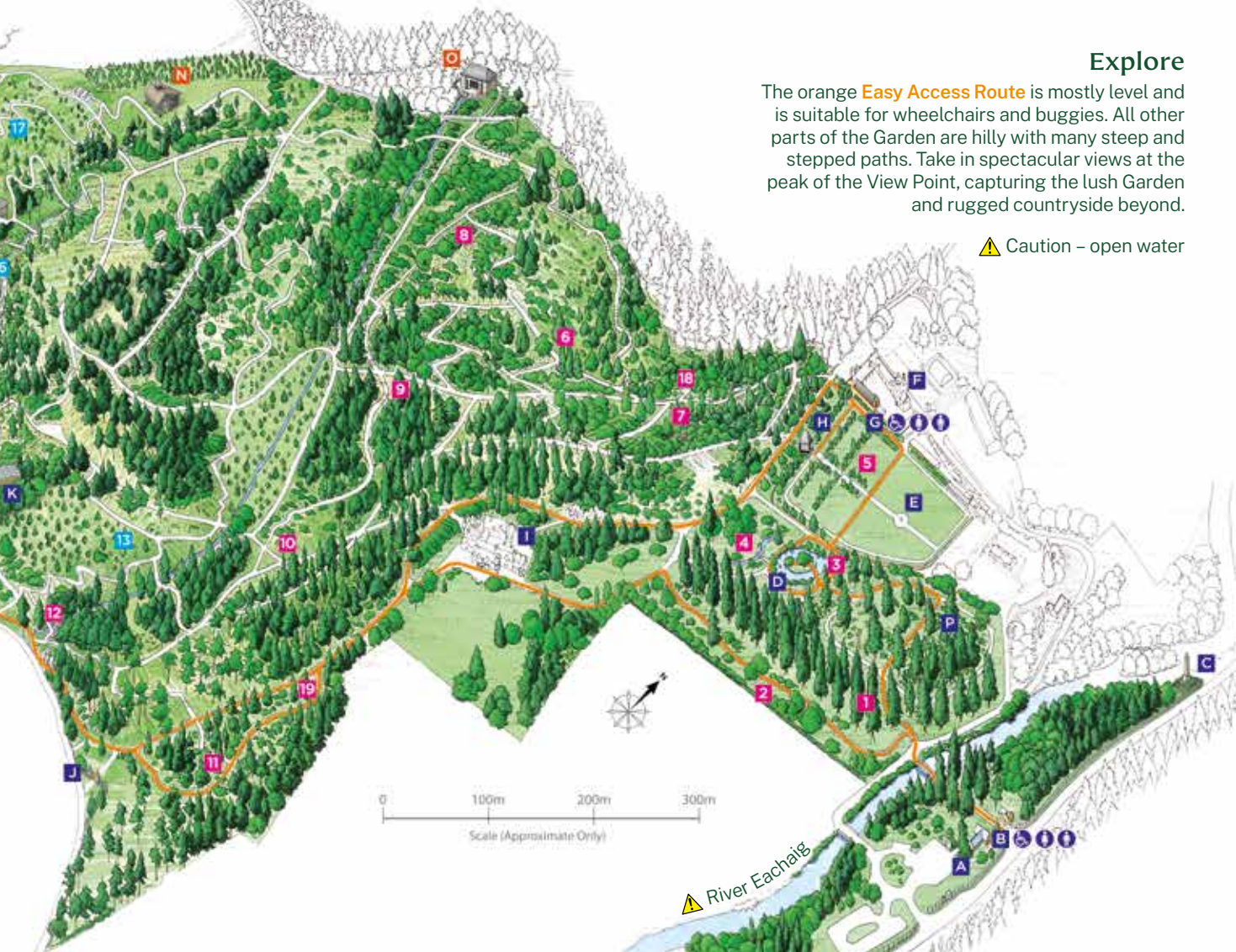

Visitor Facilities

- A** Visitor Centre
- B** Café & Shop
- C** Younger Monument
- D** Dolphin Fountain
- E** Armillary Sphere (Fletcher Memorial)
- F** Garden Offices
- G** Courtyard Gallery
- H** Puck's Hut

- I** Benmore House (Outdoor Education Centre – Private)
- J** Golden Gates
- K** Victorian Fernery
- P** Squirrel & Wildlife Hide

Mountain Shelters

- L** Bhutanese Pavilion
- M** Chilean Shelter 'The Condor'
- N** Chilean Viewpoint Refuge
- O** Wright Smith Memorial Viewpoint Shelter

Garden Areas

- 1** Redwood Avenue
- 2** Younger Memorial Walk
- 3** Pond
- 4** Stream
- 5** Walled Garden
- 6** Fir Bank (National Abies Collection)
- 7 8 9 10** Rhododendrons collection key locations

- 11** Golden Gates Arboretum
- 12** Moss & Lichen Garden
- 15** Glen Massan Arboretum
- 18 19** Silent Space

World Plantings

- 13** Japanese Valley
- 14** Tasmanian Ridge
- 16** Bhutanese Glade
- 17** Chilean Rainforest Glade